

WalzCraft®

Drawer Front Installation Tool for Face Frame Cabinets

Attaching Drawer Front to Drawer Box

Step 1.

The Drawer Front Installation Tool will assist in the correct alignment of the drawer front to the door or the drawer front beneath it.

The drawer front must have correct and consistent overlay all the way around it.

The lower doors should always be installed before the drawer fronts for proper alignment.

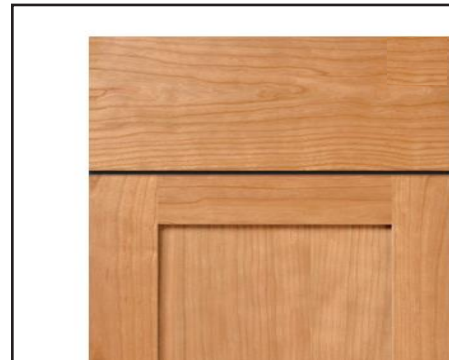

Step 2.

The Drawer Front Installation Tool can be fastened on the upper face frame rail by tightening the black knob until the tool is firmly attached to the face frame.



Step 3.

Close the drawer box until it contacts the bolt of the Drawer Front Installation Tool.

The front of the drawer box should extend slightly out from the front of the face frame.

Adjust by turning the bolt Clockwise or Counter Clockwise.

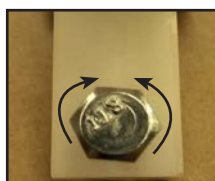

Step 4.

If the style of the drawer front will allow the use of washer head screws, drill two $\frac{5}{16}$ " holes in the front of the drawer box.



The shaft of the screw is smaller than the hole which will allow for some final adjustment if it is needed.

The washer head will cover the hole inside the box.



Continued on page 2...

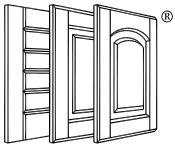

WalzCraft®

Drawer Front Installation Tool for Face Frame Cabinets

Page 2 of 2

Attaching Drawer Front to Drawer Box....cont'

Step 5.

Place two foam tabs with double sided adhesive on the front of each side of the drawer box, or the back of the drawer front, removing the protective paper.

The foam tabs will flatten out when the screws are installed.



Step 6.

To standardize the reveal and overlay, cut two spacer blocks upon which you can rest the drawer fronts.

Press the drawer front into place, aligning them with the doors beneath and any adjacent components.

Carefully open the drawer box while supporting the drawer front by keeping pressure on it.

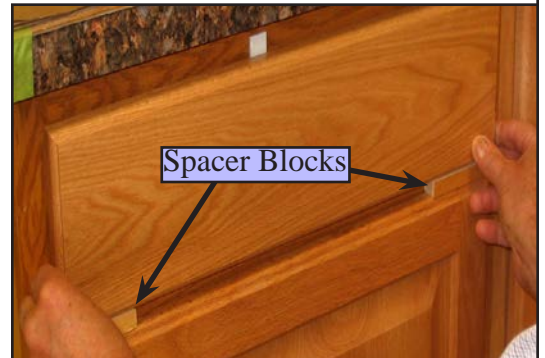

Step 7.

Hold the front securely in place by hand or use clamps.

At this point the screws can be installed.

To make final adjustments slightly loosen either screw.

Adjust the drawer front and retighten the screws.

Remove Drawer Front Installation Tool.



All Steps Completed